

MECHANICAL EXPLODED VIEW

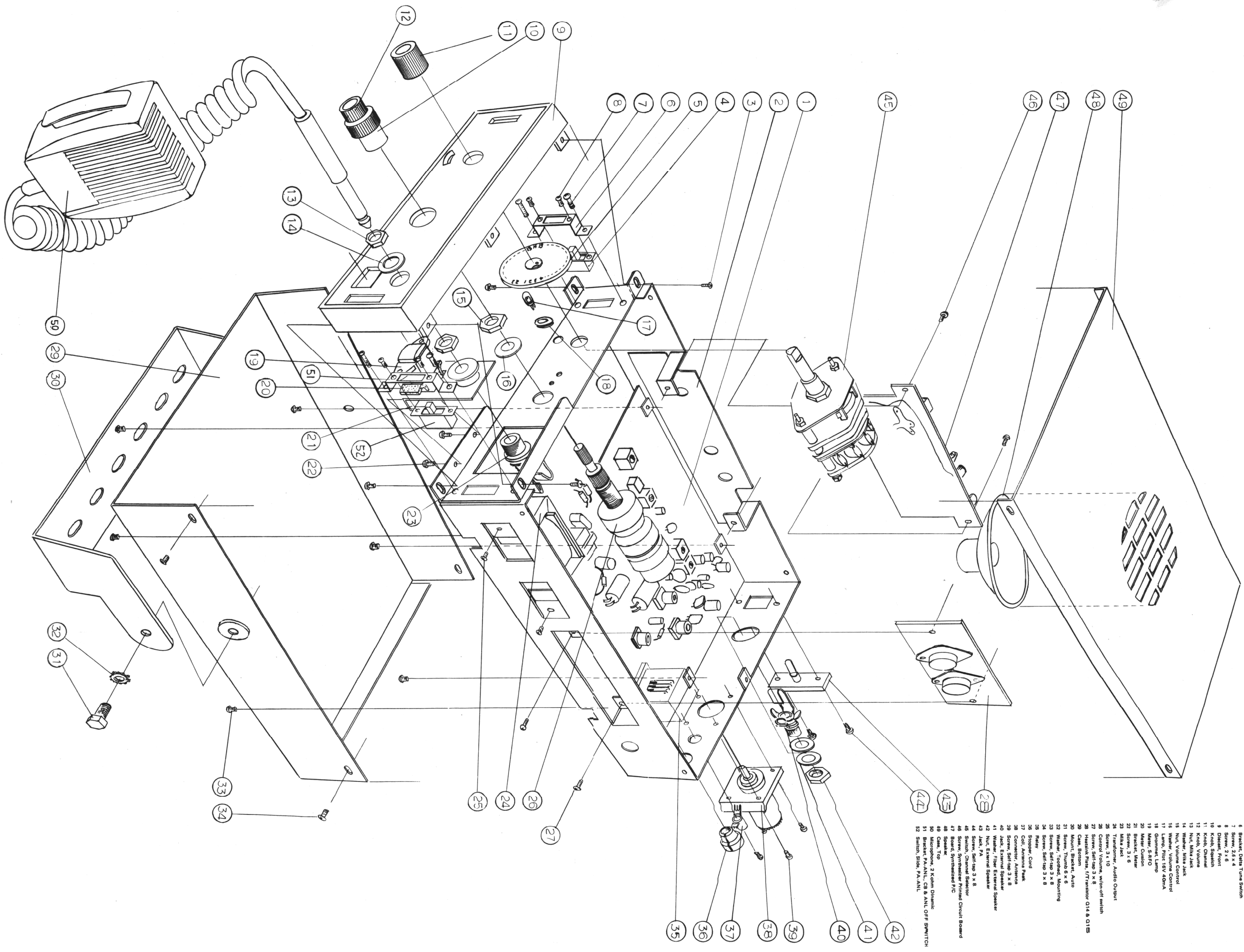

- 1 Board, Main P/C
- 2 Chassis, Main 3 x 4 8
- 3 Screws, Slide, Data Tune
- 4 Dial, Channel Indicator
- 5 Bracket, Delta Tune Switch
- 6 Bracket, Delta Tune Switch
- 7 Screw, 2.6 x 4
- 8 Screw, 2 x 6
- 9 Discs, Front
- 10 Knobs, Switch
- 11 Knobs, Volume
- 12 Nut, Milk Jack
- 13 Washer, Milk Jack
- 14 Nut, Milk Jack
- 15 Nut, Volume Control
- 16 Washer, Volume Control
- 17 Lamp, Pilot 18V 40mA
- 18 Driver, 6.8FD
- 19 Driver, 6.8FD
- 20 Meter, Custom
- 21 Bracket, Meter
- 22 Screw, 3 x 6
- 23 Mike Jack
- 24 Transformer, Audio Output
- 25 Screw, 3 x 10
- 26 Washer, w/stop, w/stop switch
- 27 Screw, Self-tap 3 x 8
- 28 Heatshrink Pipe, T/Transformer 014 & 015
- 29 Case, Bottom
- 30 Mount, Bracket, Auto
- 31 Screw, Thumb 6 x 6
- 32 Washer, "rodend, Mounting
- 33 Screw, Self-tap 3 x 8
- 34 Washer, Self-tap 3 x 8
- 35 Filter
- 36 Stopper, Cord
- 37 Coil, Antenna Peak
- 38 Connector, Antenna
- 39 Screw, Self-tap 3 x 8
- 40 Jack, External Speaker
- 41 Washer, Filter External Speaker
- 42 Jack, PA
- 43 Screw, Self-tap 3 x 8
- 44 Screw, Self-tap 3 x 8
- 45 Speaker, Top
- 46 Speaker, Bottom
- 47 Board, Synthesizer P/C
- 48 Board, Synthesizer P/C
- 49 Speaker
- 50 Switch, PA-ANL, CB & ANL OFF SWITCH
- 51 Bracket, PA-ANL, CB & ANL OFF SWITCH
- 52 Switch, Slide, PA-ANL